

FAIRFIELD LUDLOWE HIGH SCHOOL

785 Unquowa Road

Fairfield, CT 06824-5064

Phone: 203-255-7201 Fax: 203-255-7213

Greg C. Hatzis, Headmaster



September 6, 2018

Dear Fairfield Ludlowe High School Parents/Guardians,

We are looking forward to seeing you for our **OPEN HOUSE** on **Thursday, September 13, from 7:00 p.m. to 9:15 p.m.** We ask that you report to your child's homeroom by 7:00 p.m. A special Q&A session regarding our Innovation Initiative and Chromebook roll-out will take place at 6:00 pm in the auditorium for anyone interested.

This event provides an opportunity for you to meet your child's teachers and become familiar with the expectations and exciting learning opportunities in each course. In addition to visiting the classes on your child's schedule, your child's Housemaster, Dean, and Counselor will be available in the House office, or you can visit our cafeteria, the library, and the College and Career Center during free periods/study halls. I look forward to greeting you, as will our Director of Pupil Services, Vanessa Montorsi. Please understand that this event is not designed for discussions related to individual students or grades, as the time for each class is limited. We welcome you to email or call teachers separately for any specific questions you have about your child.

You will need to obtain your child's schedule ahead of time, either through Infinite Campus (**in the portal, go to "Reports" and choose FLHS OPEN HOUSE SCHEDULE**), or have your child fill out the table below. We will also have schedules available in homeroom. We will start the night in HOMEROOM which appears after Period 2 on your child's schedule. We will follow both the Day 1 and Day 2 sequence of courses for the first term (Term1). If a period is separated into two "mini" classes, only attend the class scheduled in Mini A. Our Ludlowe student leaders will be available to help you navigate the building, but a map is also attached for your reference. ***Remember to bring this completed form or the printed schedule with you.***

If you are having difficulty logging into Infinite Campus, we will have staff available in the library learning commons to assist you. Support for Naviance will also be offered in the College and Career Center. Please allow sufficient time for parking. You may use the FLHS front and back lots as well as the Roger Ludlowe Middle School lots. Thank you and we look forward to seeing you!

-Greg Hatzis, Headmaster

Student: _____ House: _____ Homeroom: _____
Counselor: _____

<u>TIME</u>	<u>PERIOD</u>	<u>SUBJECT</u>	<u>TEACHER</u>	<u>ROOM</u>
7:00-7:15	HR	Homeroom		
7:20-7:30	Day 1 Per 1			
7:35-7:45	Day 1 Per 2			
7:50-8:00	Day 1 Per 3			
8:05-8:15	Day 1 Per 4			
8:20-8:30	Day 2 Per 1			
8:35-8:45	Day 2 Per 2			
8:50-9:00	Day 2 Per 3			
9:05-9:15	Day 2 Per 4			

Only attend Mini "A" for any periods split into two Mini Periods

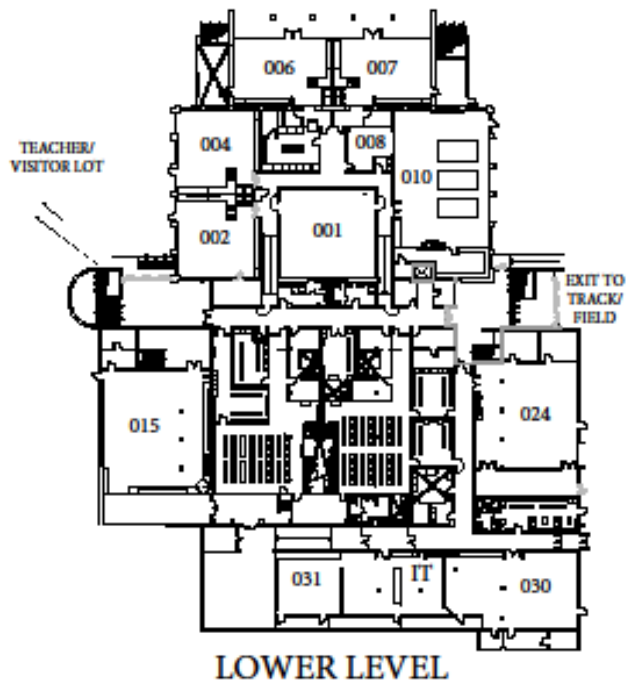

LOWER LEVEL

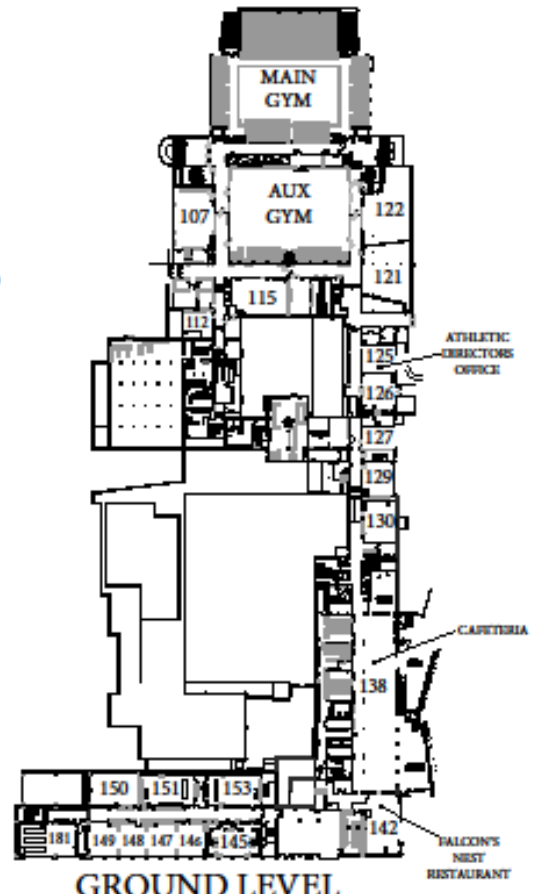

GROUND LEVEL

WELCOME TO FAIRFIELD
LUDLOWE HIGH SCHOOL

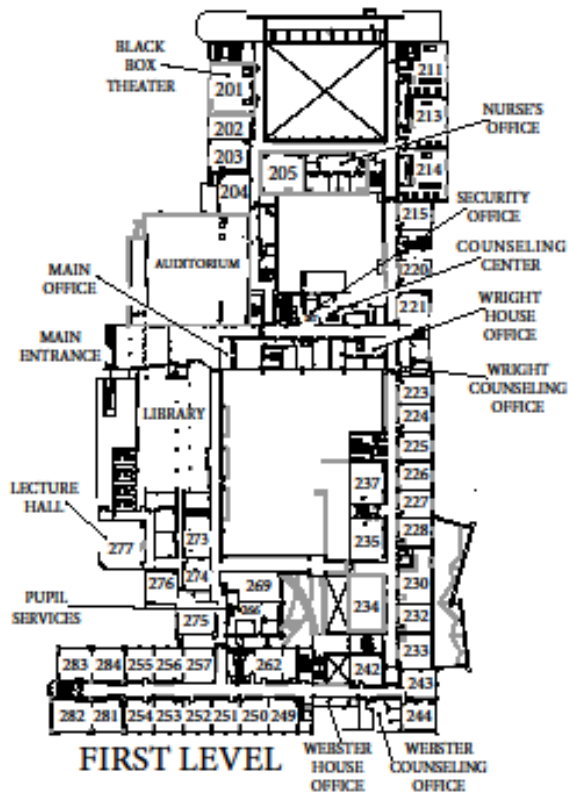

FIRST LEVEL

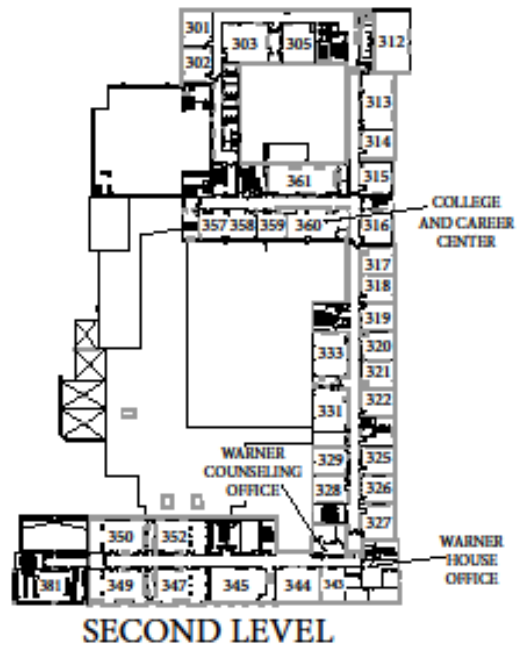

SECOND LEVEL